

Perfect PANELLING

TRANSFORMING BATHROOMS



**15 Year
Guarantee**



**Fire
retardant**



**No grout
to clean**



**Can be fixed
onto tiles**



**Quick
installation**



**100%
waterproof**

T: 01935 507171
www.perfectpanelling.co.uk

INSTALLATION GUIDE

Please read this guide carefully before installing your Perfect Panelling wall panels.

Where can Perfect Panelling wall panels be used?

Most people install our panels in their bathrooms and wet rooms, but they can be used in any room within a house, office, or business premises.

Before you install - **CHECK CONTENTS**

- Panels are supplied boxed, please check all panels are from the same batch to ensure uniform colour.
- Check for any visual defects prior to installation including the edges. Any claim for visual defects present in the panels after fitting cannot be accepted.
- Slight colour variations may be found between panels due to the printing process involved and are not grounds for complaint.
- Some patterns may not continue across multiple panels - check with our team if you're unsure before proceeding with installation.
- **Once the panels have been installed, they are deemed to be acceptable in relation to any visual defects.**

Tools & Accessories

- Trims, adhesive and silicone
- Sealant gun
- Tape measure
- Handsaw, jigsaw or circular saw with fine tooth blade
- Pencil
- Utility knife
- 1200mm spirit level
- Drill
- Masking tape
- Suction grips
- Protective gloves
- Protective goggles
- Ear protection

Storing panels prior to installation

- Always store Perfect Panelling panels flat on their widest face to prevent bowing in dry clean area.

- Try to acclimatise the panels in the environment where they are to be installed for at least 24 hours before installation.
- Always handle the panels carefully to avoid damage.

Adhesive & Sealants

- For a 1000mm wide panel we recommend using two tubes of high grab, MS Polymer based adhesive such as Perfect Panelling's own Max Grab adhesive.
- Two tubes of Perfect Panelling's Perfect Seal.

Trims

- Tongue and groove panels do not require joining strips when fixing adjacent to each other, but they may require an end cap, internal or external trim.
- If fitting flat edge panels an 'H' shaped joining strip can be used to fix the panels securely and should be used if creating a watertight seal.



EXTERNAL
CORNER



END CAP



INTERNAL
CORNER

Installation

Panels can be fixed straight onto existing tiles providing they are not damaged. To fix panels onto a bare wall, it's essential to ensure the wall is flat and level and ideally free of existing mould or damp.

DAMAGED/ UNEVEN WALLS?

Plywood and Wood Plastic Composite (WPC) panels can be attached to imperfect walls by fitting 38mm x 19mm battens horizontally at 400mm centres with screws into wall plugs - a breathable membrane is also recommended.

NEWLY PLASTERED WALLS?

Apply PVA to seal the wall so that the panel adhesive is not absorbed through the plaster. If this is not done it could result in the panels coming away from the wall.

1. If using an internal trim, start by measuring and cutting it to the required height with a fine

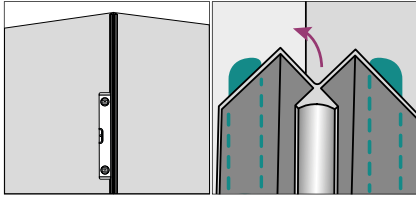

2. Apply adhesive to the outer edges of the trim ensuring it is first positioned on a level surface before fitting in place.

3. If using our recommended CladSeal strips on the bottom of a shower tray, measure and cut with a fine tooth saw.

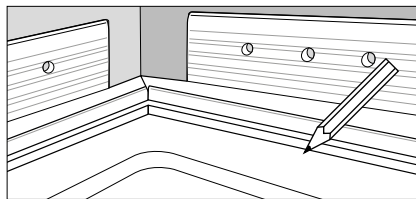

4. Run adhesive on the back and base of the of the Cladseal and fit in place.

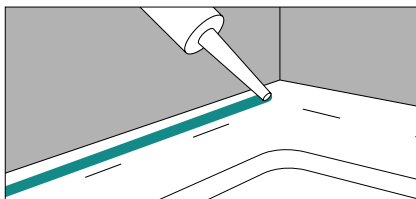

5. Measure the area where the panels will be installed and mark these out on the panel in pencil. Remember that when measuring the distance from walls or inside shower enclosures, allowances should be made for the depth of the panel.

6. Once you are happy with the measurements, cut the panel with a jigsaw or a fine tooth saw (whichever you prefer), keeping the decorative side face up, carefully cut the panel to the desired measurements.

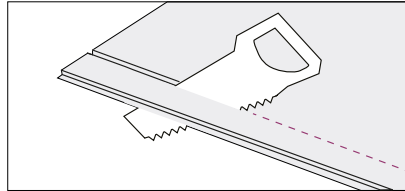

7. Before applying any adhesive, position the panel to the wall to double check it fits wells and then move to one side.

8. Apply an MS Polymer based adhesive to the wall or rear of the panel in a zig zag pattern – we recommend one tubes per panel.

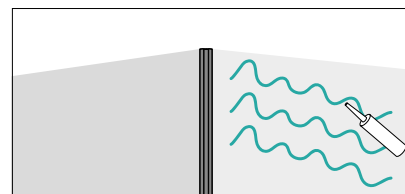

9. Fix the panel against the wall and into the corner trim and smooth out any air pockets. Use a spirit level to check the panel is vertically level. Repeat the process for the required number of panels.

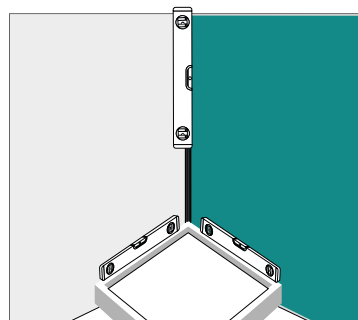

10. When joining tongue and groove panels together, it's important to apply a 3-5mm bead of silicone sealant to the front shoulder of the groove.

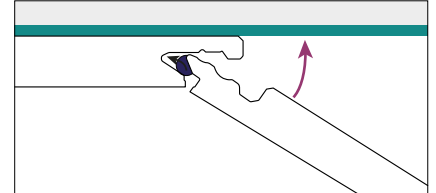

NOTE: Using too much sealant could compromise the strength of the joint and using too little could limit the waterproof effectiveness.

11. Measure and cut end trims to the required length, apply the adhesive, and fit into place.

12. Seal the top of the panel with silicone where it meets the ceiling and seal any additional gaps around any fixtures or fittings.

13. Wipe away any excess silicone, using a damp cloth and washing-up liquid.

14. If you need to mount load bearing accessories such as shower caddies or handles, be sure to first drill through the panel at the point where the fixing is to be located and insert a metal or wood spacer. Insert a suitable wall fixing (this will depend on what type of surface the panels are being fixed onto) and attach the required accessory. **NOTE: This is not required when using our Plywood or WPC based panels.**

15. Job done! Nice work, now take a picture and send it to info@perfectpanelling.co.uk so we can add it to our 'hall of fame.'

Cleaning, Care and Maintenance

Wall panels are excellent at preventing bacteria and mould growth due to their non-porous surface. They are easy to clean and only require a wipe over with a soft cloth and a non-abrasive cleaner. Do not use abrasive cleaner, neat bleach, or harsh scouring pads as this will damage the panels.

Sealants may need to be replaced periodically, and or as necessary dependant upon shower usage and normal sealant degradation and is a normal good maintenance procedure. Failure to maintain exposed sealants as necessary may result in water ingress into the panel core and subsequent panel damage and will invalidate your guarantee. **Note - low quality sealants may shrink over time and jeopardise the water integrity of the installation.**



**100%
waterproof**

100% WATERPROOF

The innovative 'tongue and groove' system prevents drips and leaks which can travel through walls and ceilings causing water damage.



**Quick
installation**

QUICK INSTALLATION

On average panels take 50% less time to install than traditional tiles.



**Can be fixed
onto tiles**

CAN BE FIXED DIRECTLY ONTO TILES

Panels can also be fixed directly onto walls with existing ceramic tiles, using a moisture cure or solvent free adhesive (tiles do not have to be removed).



**No grout
to clean**

NO GROUT TO CLEAN

Gain back valuable time with no additional grout to clean – just use a suitable non-abrasive UPVC cleaner and wipe down.



**Fire
retardant**

CLASS 1 FIRE RETARDANT

Our wall panels can withstand temperatures up to 60°C and can be fitted behind hot water pipes and radiators and behind a gas or electric hob if a piece of heat resistant glass is installed between the panel & the hob using 10mm spacers and mirror screws.



**15 Year
Guarantee**

15 YEAR GUARANTEE

Our panels are strong and durable, rivalling the life span of traditional tiles (applies to Perfect Panelling's Reva and Maya range, other panels are covered by manufacturer's guarantee).



TRANSFORMING BATHROOMS

T: 01935 507171

www.perfectpanelling.co.uk

Unit 6, Brympton Way, Yeovil, BA20 2HP